

Meeting rooms set up plans

Meeting room: **BARONS**
Set up: **Theatre (max 110 persons)**

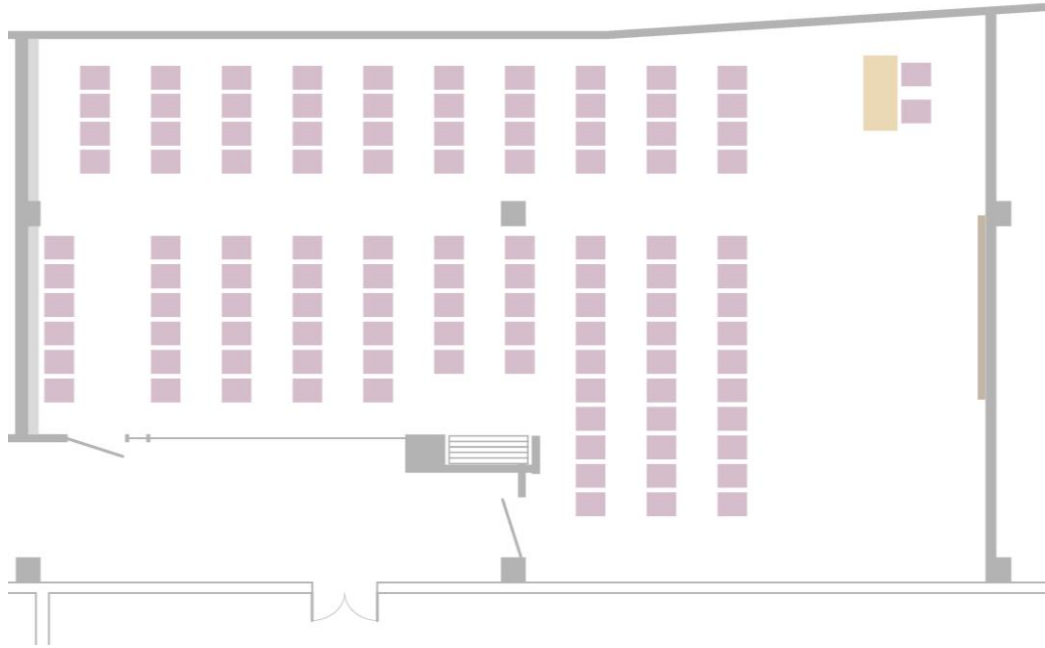

Meeting room: **BARONS 1**
Set up: **Theatre (max 40 persons)**

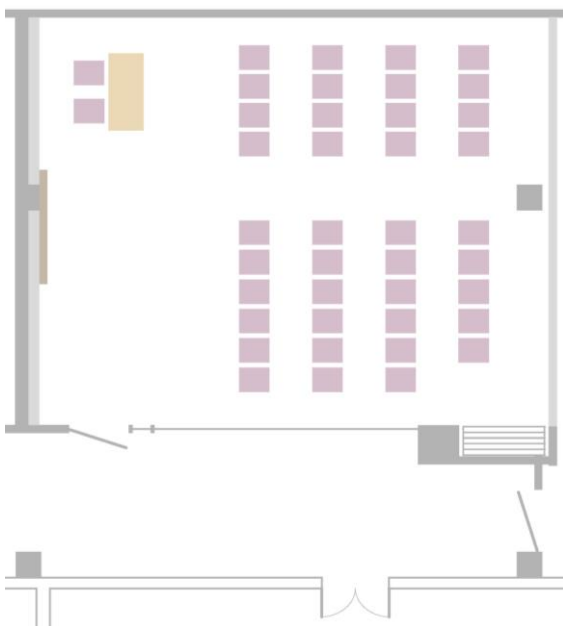

Meeting room: **BARONS 2**
Set up: **Theatre (max 52 persons)**

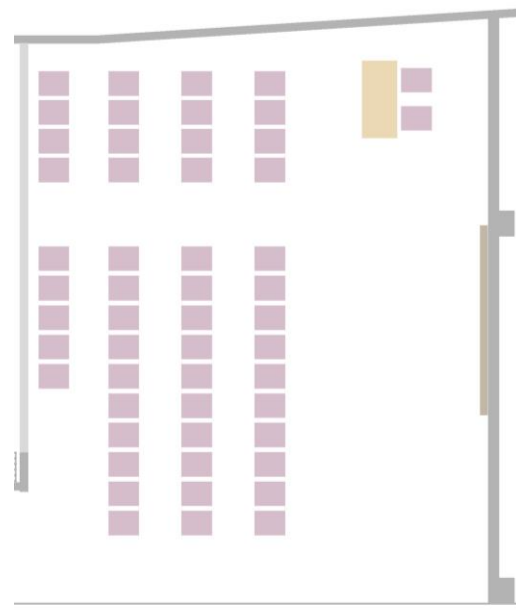

Meeting rooms set up plans

Meeting room: **BARONS**

Set up: **Classroom (max 60 persons)**

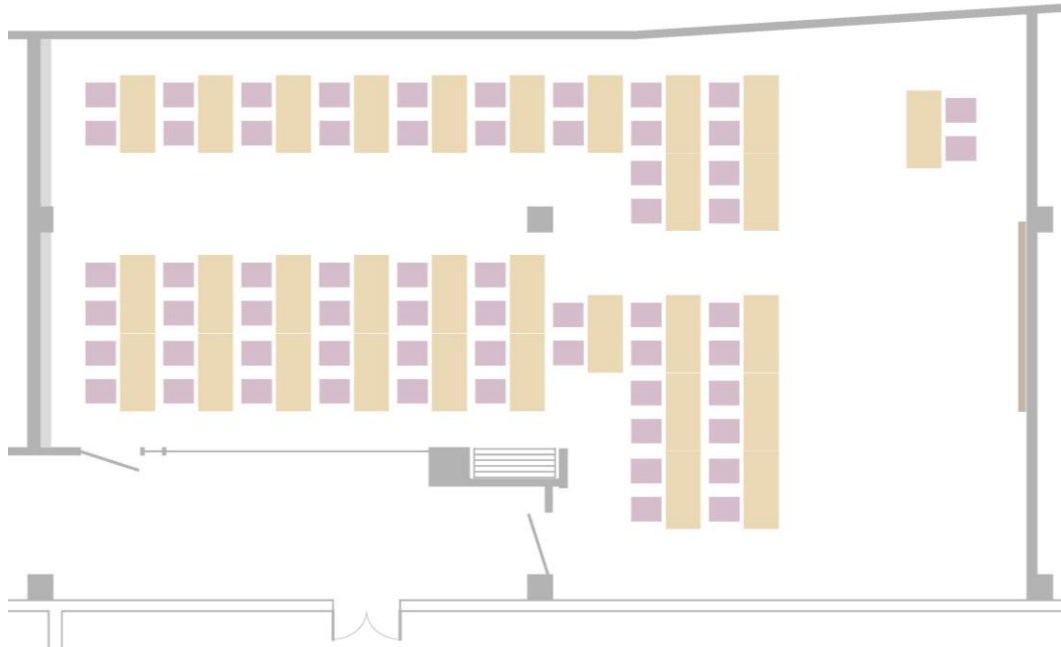

Meeting room: **BARONS 1**

Set up: **Classroom (max 24 persons)**

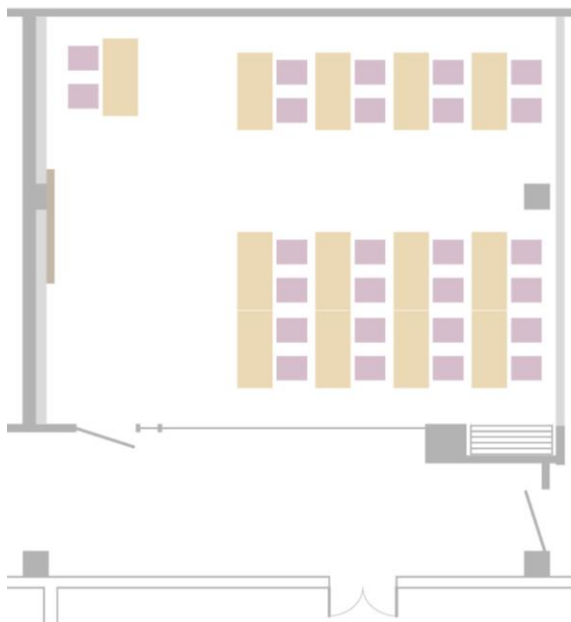

Meeting room: **BARONS 2**

Set up: **Classroom (max 28 persons)**

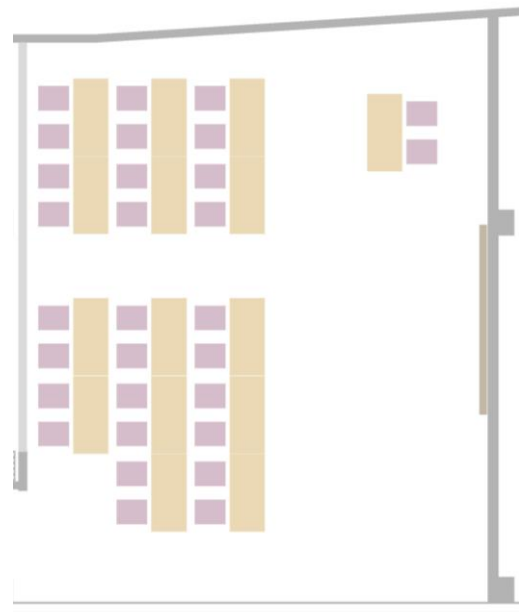

Meeting rooms set up plans

Meeting room: **BARONS 1**
Set up: **O-shape (max 30 persons)**

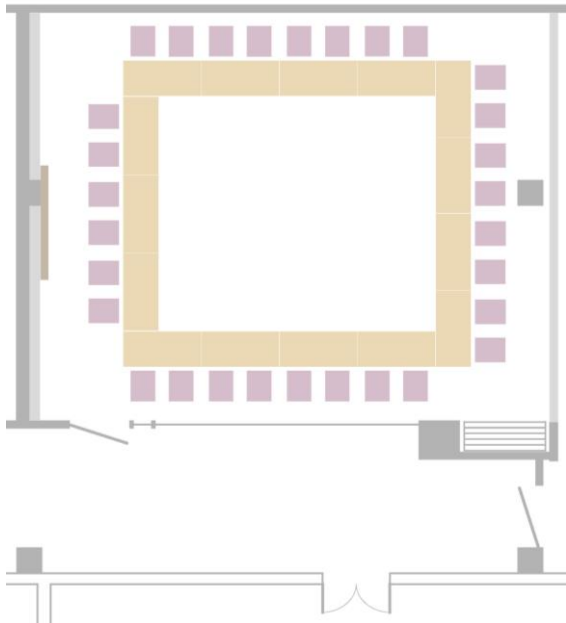

Meeting room: **BARONS 2**
Set up: **O-shape (max 36 persons)**

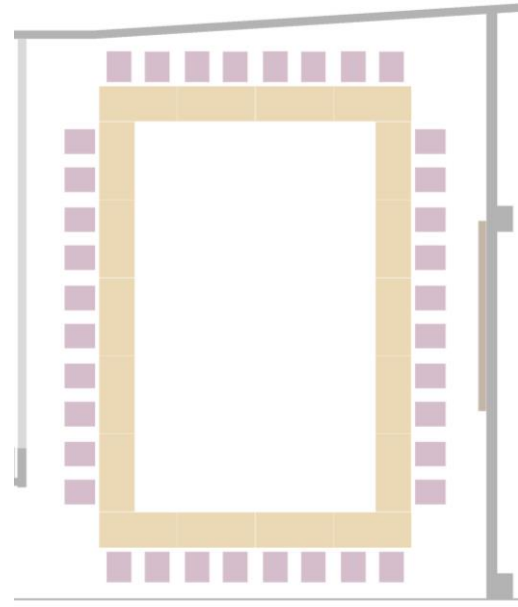

Meeting room: **Daina**
Set up: **O-shape (max 12 persons)**

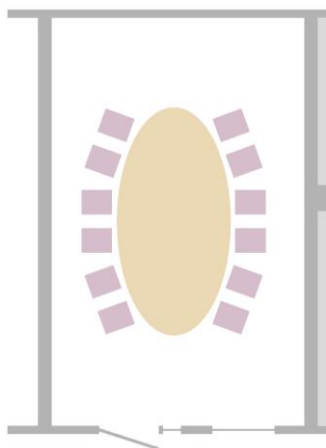

Meeting rooms set up plans

Meeting room: **BARONS 1**
Set up: **U-shape (max 22 persons)**

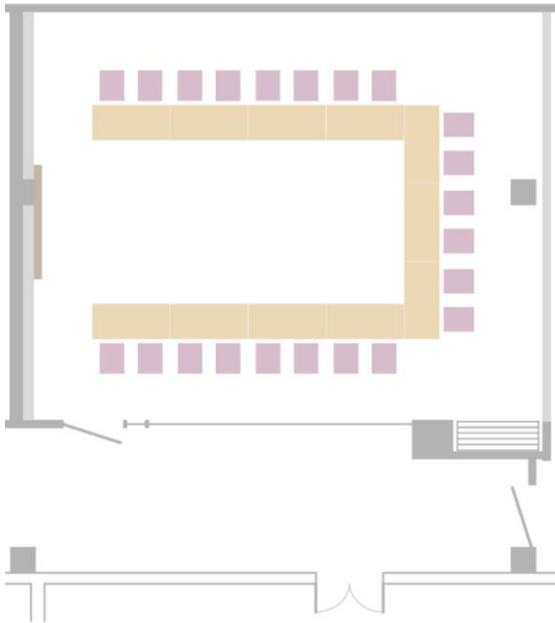

Meeting room: **BARONS 2**
Set up: **U-shape (max 26 persons)**

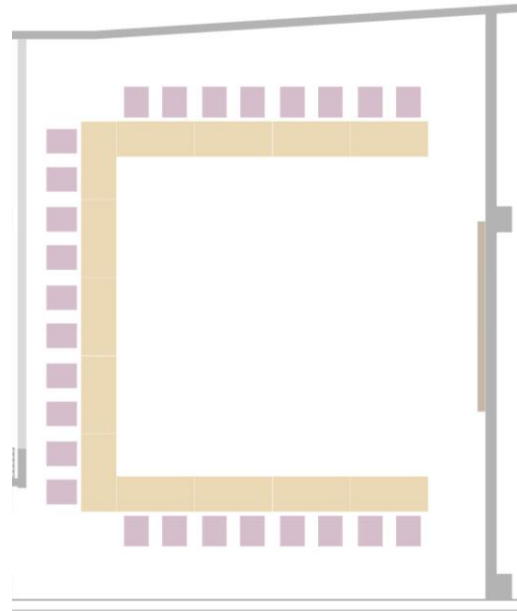

Meeting room: **BARONS 1**
Set up: **Cabaret (max 20 persons)**

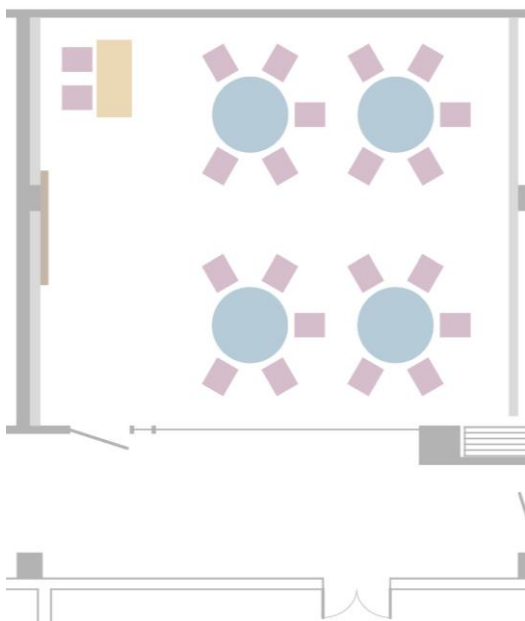

Meeting room: **BARONS 2**
Set up: **Cabaret (max 25 persons)**

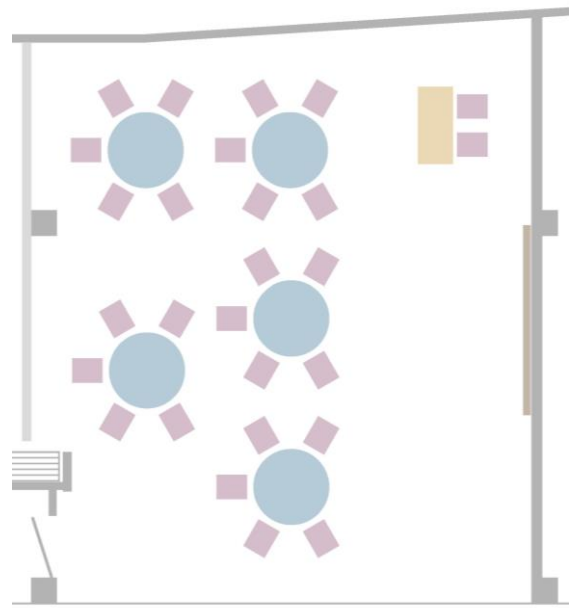

Meeting rooms set up plans

Meeting room: **BARONS**

Set up: **Banquet (max 66 persons)**

